

# SATO702 Slab w/ Pan, Bird Door and Stool

## Model Numbers:

- SATO702

## Features/Benefits:

- 1200 x 800mm blow-molded slab
  - Lightweight and sturdy design facilitates easy and fast latrine floor construction
- Meets UNHCR procurement requirements
- For direct pit application
- Comfortable western-style sitting toilet
  - Especially great for the elderly, people with disabilities or pregnant users
  - Durable material that is chemical resistant and vandalism resistant
  - Smooth surfaces for easy cleaning
  - Mounting holes to securely attach stool to slab
- Self-closing trap door design allows for a small amount of water to create a seal between waste and human environment
  - Minimizes odor and harmful gases - door remains in closed position unless in use or when flushing
  - Prevents insects from entering and escaping pits preventing spread of diseases
  - Water saving
  - Water seal depth: up to 7mm
- Integrated plastic counterweight for areas where other counterweight materials (e.g. cement or rubber) are not easily accessible
- Closed aperture ensures sense of safety, especially for children
- Includes hardware for mounting pan and stool to slab
- Includes iron pegs (x4) to secure slab to the ground

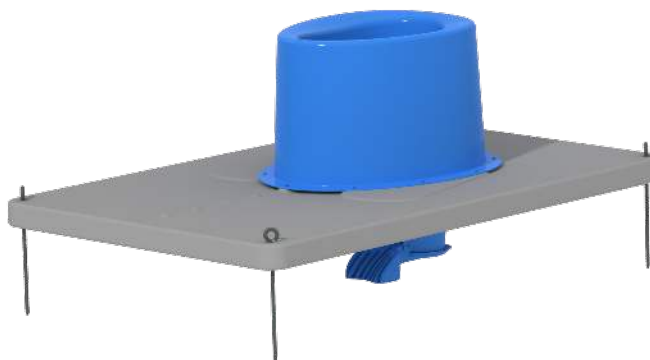

## Description:

**SATO702:** An all-in-one latrine flooring solution. Includes slab, pan, stool and door for direct pit setup

## Technical specifications:

### Dimensions:

SATO702: 1200 x 800 x 536mm (excl. pegs)

### Material:

Slab: High-Density Polyethylene

Pan, Stool and Trap Door: Polypropylene

Pegs: Irons

Hardware: Stainless Steel

### Weight (approx.):

Slab: 11kg

Pan: Approx. 397g

Stool: Approx. 1.8kg

Door: Approx. 137g

Pegs (x4): 113g each

Total: 13.8kg

**Suggested Flush Volume:** 500 mL

# SATO702 Slab w/ Pan, Bird Door and Stool

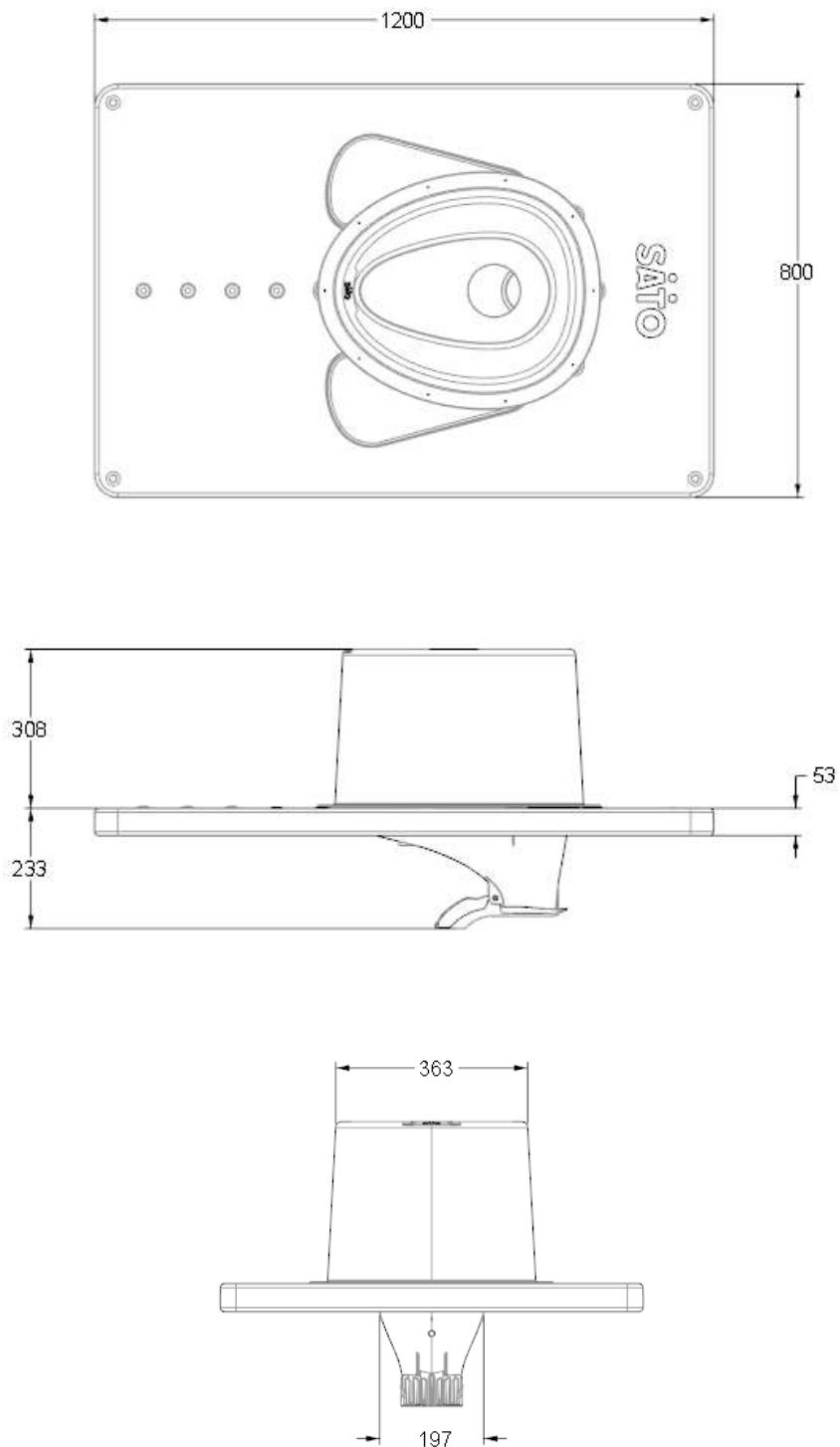

*(Iron pegs not shown on views)*