

SATO173 "RURAL" PAN W/ BIRD DOOR

Model Numbers:

- SATO173
- SATO173W

Features/Benefits:

- Self-closing trap door design allows for a small amount of water to create a seal between waste and human environment
 - Minimizes odor and harmful gases - door remains in closed position unless in use or when flushing
 - Prevents insects from entering and escaping pits preventing spread of diseases
 - Water saving
 - Water seal depth: up to 7mm
- Integrated plastic counterweight for areas where other counterweight materials (e.g. cement or rubber) are not easily accessible
- Closed aperture ensures sense of safety, especially for children
- Mounting holes on flange for secure fitment to slab

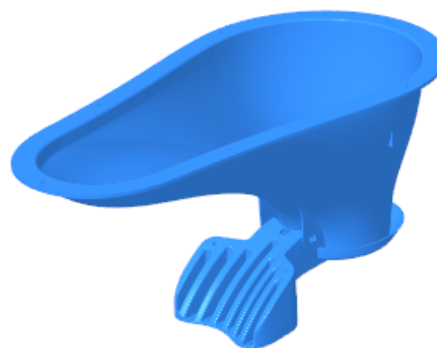

Description:

SATO173: Original SATO toilet pan with advanced door design to reduce water consumption. Mounting holes on flange for secure fitment to slab.

SATO173W: Original SATO toilet pan with advanced door design to reduce water consumption. Mounting holes on flange for secure fitment to slab. Pan in white color

Technical specifications:

Dimensions:

SATO103: 464 x 248 x 225mm
Pan Interior: 419 x 203 x 191mm

Weight (Approx.):

Pan: 397g
Door: 137g

Material:

Pan and Trap Door: Polypropylene

Suggested Flush Volume: 500 mL

SATO173 "RURAL" PAN W/ BIRD DOOR

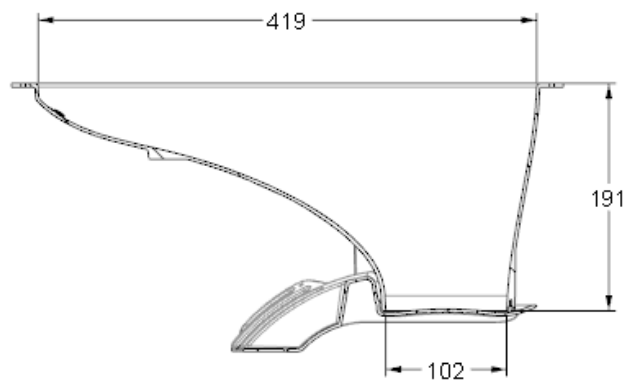
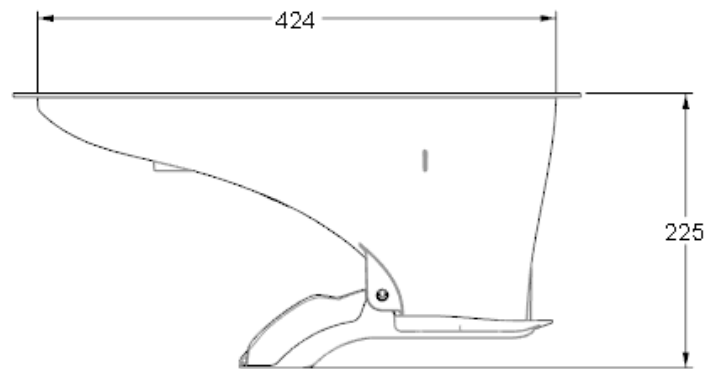
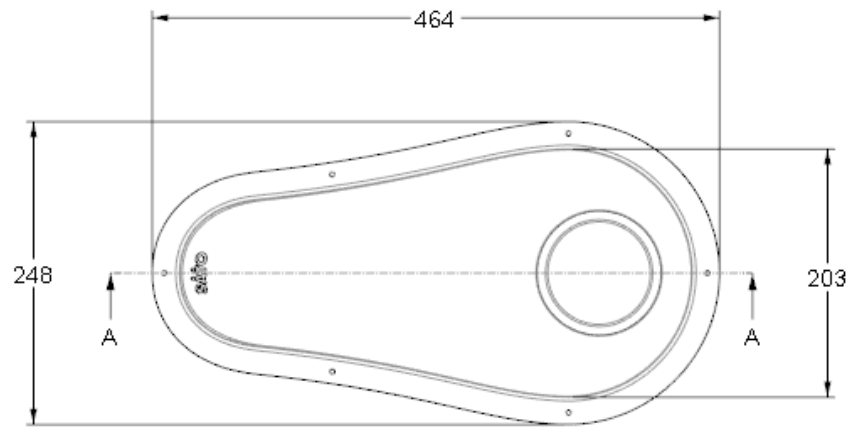

SECTION A-A